

TORREON
N-E

TORREON
S-E

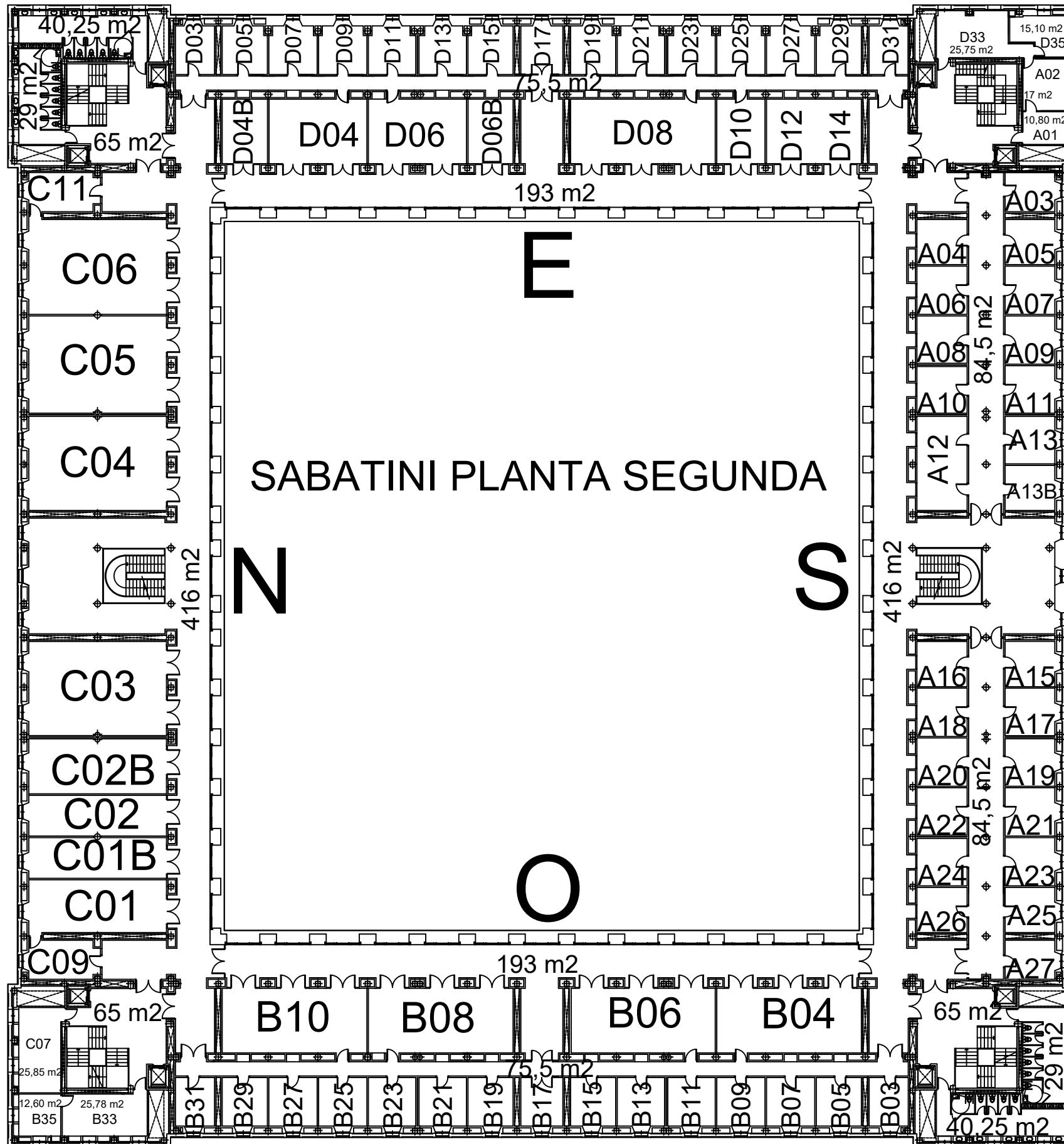
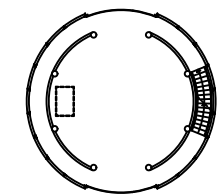

SABATINI PLANTA SEGUNDA

| | |
|-----------------------------|------------------------|
| Superficie total construida | 5260,5 m ² |
| Superficie útil ocupada | 2065 m ² |
| Superficie útil común | 2050,25 m ² |

TORREON
N-O

TORREON
S-O

| Señalización | Superficie | Señalización | Superficie |
|--------------|----------------------|----------------|---------------------------|
| 2.2.A.03 | 14.50 m ² | 2.2.B.19 | 16.25 m ² |
| 2.2.A.04 | 16.25 m ² | 2.2.B.21 | 17 m ² |
| 2.2.A.05 | 16.75 m ² | 2.2.B.23 | 17 m ² |
| 2.2.A.06 | 17.25 m ² | 2.2.B.25 | 17.50 m ² |
| 2.2.A.07 | 17.75 m ² | 2.2.B.27 | 17.50 m ² |
| 2.2.A.08 | 17 m ² | 2.2.B.29 | 16.25 m ² |
| 2.2.A.09 | 17.75 m ² | 2.2.B.31 | 14.25 m ² |
| 2.2.A.10 | 16.75 m ² | 2.2.C.01 | 51.75 m ² |
| 2.2.A.11 | 17.50 m ² | 2.2.C.01B | 40 m ² |
| 2.2.A.12 | 33.75 m ² | 2.2.C.02 | 40 m ² |
| 2.2.A.13 | 17 m ² | 2.2.C.02B | 54 m ² |
| 2.2.A.13B | 17 m ² | 2.2.C.03 | 93.50 m ² |
| 2.2.A.15 | 16.75 m ² | 2.2.C.04 | 93.50 m ² |
| 2.2.A.16 | 16.75 m ² | 2.2.C.05 | 96.75 m ² |
| 2.2.A.17 | 17.50 m ² | 2.2.C.06 | 94.75 m ² |
| 2.2.A.18 | 17.25 m ² | 2.2.C.09 | 20.25 m ² |
| 2.2.A.19 | 16.50 m ² | 2.2.C.11 | 20.25 m ² |
| 2.2.A.20 | 17.25 m ² | 2.2.D.03 | 14.25 m ² |
| 2.2.A.21 | 17.75 m ² | 2.2.D.04-06 | 45 m ² |
| 2.2.A.22 | 17 m ² | 2.2.D04B-06B | 20.75 m ² |
| 2.2.A.23 | 17.75 m ² | 2.2.D.05 | 16 m ² |
| 2.2.A.24 | 17 m ² | 2.2.D.07 | 17 m ² |
| 2.2.A.25 | 16.75 m ² | 2.2.D.08 | 67.25 m ² |
| 2.2.A.26 | 16.25 m ² | 2.2.D.09 | 17 m ² |
| 2.2.A.27 | 14.50 m ² | 2.2.D.10-12-14 | 66 m ² (total) |
| 2.2.B.03 | 14.25 m ² | 2.2.D.11 | 16.50 m ² |
| 2.2.B.04 | 67.25 m ² | 2.2.D.13 | 16.50 m ² |
| 2.2.B.05 | 16.25 m ² | 2.2.D.15 | 16 m ² |
| 2.2.B.06 | 67.25 m ² | 2.2.D.17 | 15 m ² |
| 2.2.B.07 | 17.50 m ² | 2.2.D.19 | 16 m ² |
| 2.2.B.08 | 67.25 m ² | 2.2.D.21 | 16.50 m ² |
| 2.2.B.09 | 17.50 m ² | 2.2.D.23 | 16.50 m ² |
| 2.2.B.10 | 67.25 m ² | 2.2.D.25 | 17 m ² |
| 2.2.B.11 | 17 m ² | 2.2.D.27 | 17 m ² |
| 2.2.B.13 | 17 m ² | 2.2.D.29 | 16 m ² |
| 2.2.B.15 | 16.25 m ² | 2.2.D.31 | 14.25 m ² |
| 2.2.B.17 | 15.25 m ² | | |

Última actualización: abril de 2021